

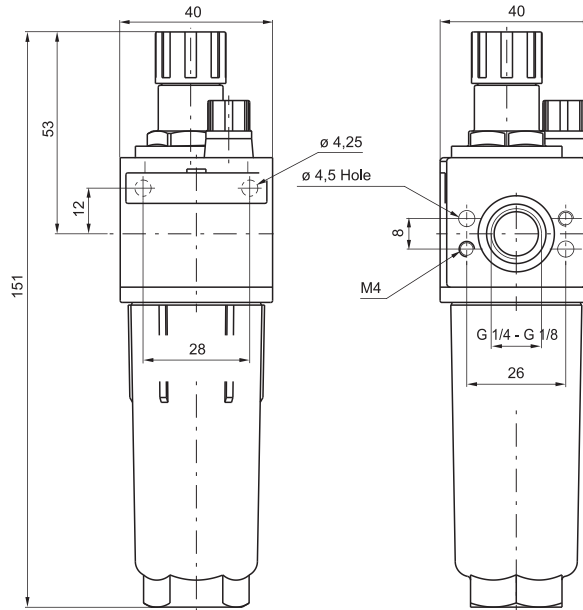

Lubricator



Ordering code

17V03C.T

VERSION

- V 0 = Zinc alloy body
- 1 = Technopolymer body

CONNECTIONS

- C A = G 1/8"
- B = G 1/4"

TYPE

- P = Bowl protection

Example: 17103A.P
Lubricator size 1 with G 1/8" connections and bowl protection with technopolymer body.

Flow rate curves

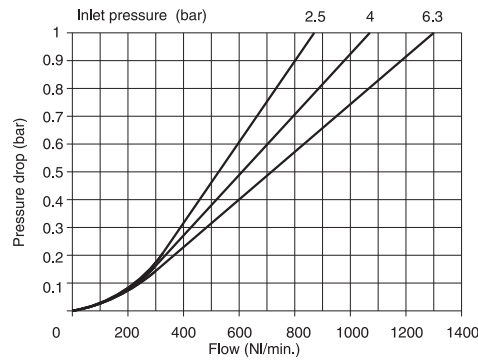

Operational characteristic

- Fog type lubrication with variable section orifice according to the flow.
- Zinc alloy body or reinforced technopolymer body with threaded aluminum insert connections.
- Wall mounting possibility with M4 screws protected by covers.
- Transparent technopolymer bowl screwed to the body.
- Technopolymer shock resistant bowl protection.
- Possibility to see the min. and max. oil level on 360° also with bowl protection assembled.
- Transparent technopolymer sight dome with adjusting handle.
- Oil filling plug (Available only for technopolymer body versions).

Technical characteristic

Connections	G 1/8" - G 1/4"
Max working pressure (bar)	13 bar - 1,3 MPa
Temperature °C	50°C
Weight with technopolymer body	gr. 108
Weight with zinc alloy body	gr. 258
Indicative oil drop rate	1 drop every 300/600 NI
Oil type	FD22 - HG32
Bowl capacity	36 cm ³
Assembly position	Vertical
Wall fixing screw	M4
Max. fittings torque on zinc alloy body	30 Nm
Max. fittings torque on technopolymer body	15 Nm
Min. operational flow at 6,3 bar	10 NI/min.

Lubricator

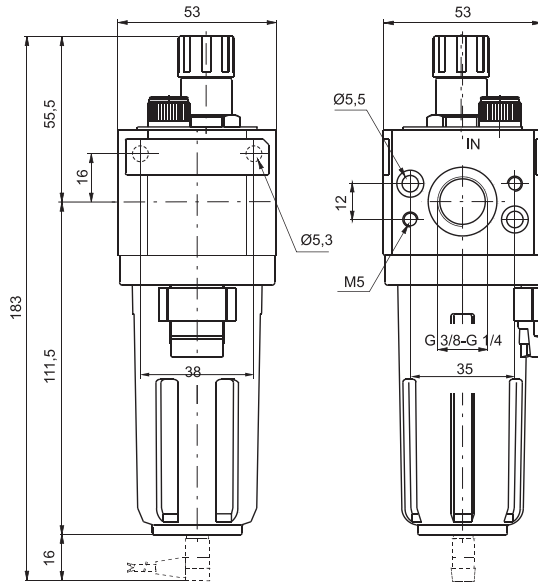

Ordering code

17203C.T

CONNECTIONS	
C	A = G 1/4"
	B = G 3/8"
TYPE	
	MA = Min. oil level indicator N.O. with plug connector
T	MC = Min. oil level indicator N.C. with plug connector

Example: 17203A : Lubricator with G 1/4" connections.

Note: on the MA version the contact is open when oil is present; on the MC version the contact is closed when oil is present

Flow rate curves

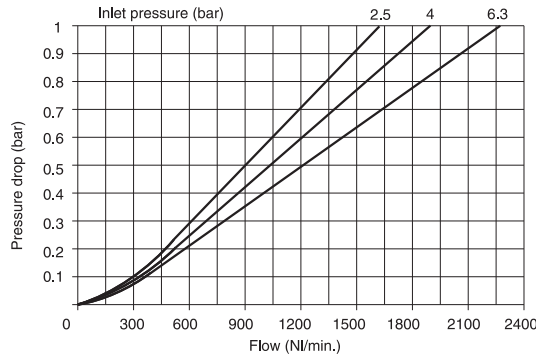

Operational characteristic

- Fog type lubrication with variable section orifice according to the flow.
- Body made with light alloy.
- Wall mounting possibility with M5 screws protected by covers.
- Transparent technopolymer bowl with shock resistant technopolymer protection
- Possibility to see the min. and max. level on 360° also with bowl protection assembled.
- Bowl assembled to the body with bayonet cap and safety button.
- Transparent technopolymer sight dome with adjusting handle.
- Oil filling plug.
- Electrical connector for low level indication.
- Use the C1, C2 or C3 lead for connection (see section 6 "Sensors").

Technical characteristic

Connections	G 1/4" - G 3/8"
Max working pressure (bar)	13 bar - 1,3 MPa
Temperature °C	50°C
Pressure gauge connections	G 1/8"
Weight	gr. 280
Indicative oil drop rate	1 drop every 300/600 NI
Oil type	FD22 - HG32
Bowl capacity	52 cm ³
Assembly position	Vertical
Wall fixing screw	M5
Min. operational flow at 6,3 bar	20 NI/min
Max. fittings torque	25 Nm

Lubricator

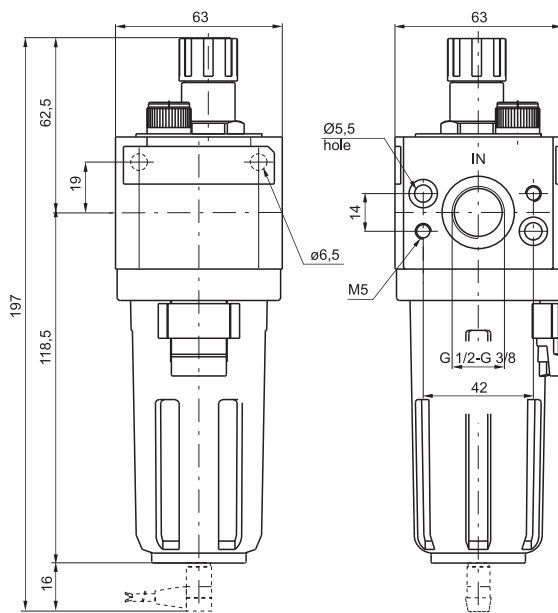

Ordering code

17303C.T

CONNECTIONS	
C	A = G 3/8"
	B = G 1/2"
TYPE	
	MA = Min. oil level indicator N.O. with plug connector
T	MC = Min. oil level indicator N.C. with plug connector

Example: 17303A
Lubricator with G 3/8" connections.
Note: on the MA version the contact is open when oil is present; on the MC version the contact is closed when oil is present

Flow rate curves

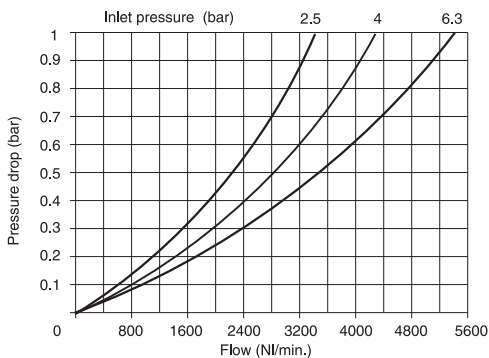

Operating Characteristics

- Fog type lubrication with variable section orifice according to the flow.
- Body made with light alloy.
- Wall mounting possibility with M5 screws protected by covers.
- Transparent technopolymer bowl with shock resistant technopolymer protection
- Possibility to see the min. and max. level on 360° also with bowl protection assembled.
- Bowl assembled to the body with bayonet cap and safety button.
- Transparent technopolymer sight dome with adjusting handle.
- Oil filling plug.
- Electrical connector for low level indication.
- Use the C1, C2 or C3 lead for connection (see chapter 6 "Sensors").

Technical characteristics

Connections	G 3/8" - G 1/2"
Max working pressure (bar)	13 bar - 1,3 MPa
Temperature °C	-5 °C - 50°C
Weight	gr. 435
Indicative oil drop rate	1 drop every 300/600 NI
Oil type	FD22 - HG32
Bowl capacity	62 cm ³
Assembly position	Vertical
Wall fixing screw	M6
Min. operational flow at 6,3 bar	20 NI/min
Max. fittings torque	40 Nm



Lubricator

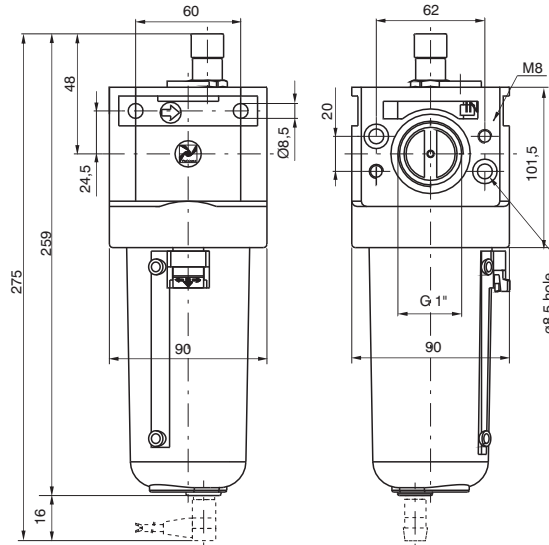

Ordering code

17403B.1

TYPE

- 1** MA = Min. oil level indicator N.O. with plug connector
- MC = Min. oil level indicator N.C. with plug connector

Example: 17403B

Lubricator size 4 with G 1" connections.

Note: on the MA version the contact is open when oil is present; on the MC version the contact is closed when oil is present

Flow rate curves

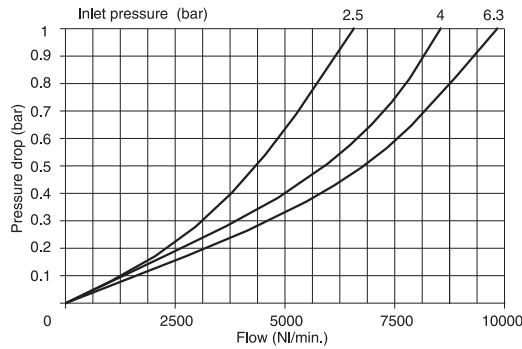

Operational characteristic

- Fog type lubrication with variable section orifice according to the flow.
- Body made with light alloy.
- Wall mounting possibility with M8 screws protected by covers.
- Light alloy bowl c/w level indicator connected to the body with bayonet cap and safety button.
- Transparent technopolymer sight dome with adjusting handle.
- Oil filling plug.
- Electrical connector for low level indication. Use the C1, C2 or C3 lead for connection (see section 6 "Sensor").

Technical characteristic

Connections	G 1"
Max working pressure (bar)	13 bar - 1,3 MPa
Temperature °C	50°C
Weight	gr. 1500
Indicative oil drop rate	1 drop every 300/600 NI
Oil type	FD22 - HG32
Bowl capacity	300 cm ³
Assembly position	Vertical
Wall fixing screw	M8
Min. operational flow at 6,3 bar	100 NI/min

3