

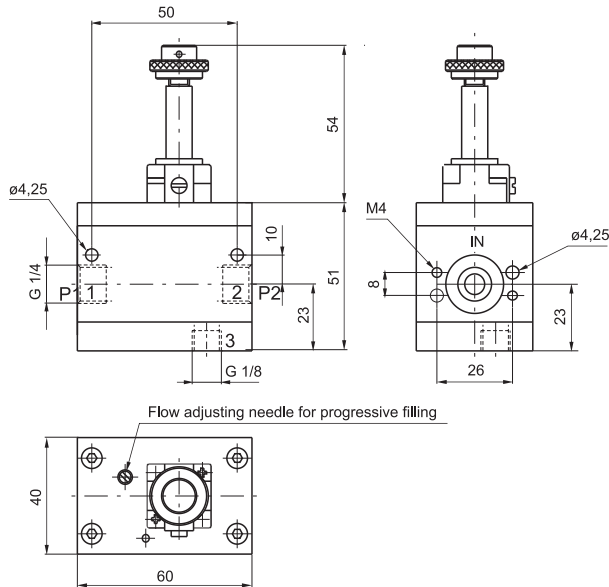

Progressive start-up valve



Ordering code

171T

TYPE

- T** 10.M2 = Electric control complete with M2 mechanic (see pag. 2.15)
- 20 = with pneumatic control

Important note: the preventive or programmed maintenance of this product is not foreseen considering the elaborated assembling and the specific "PNEUMAX" testing; therefore, call the producer or its representative in case of necessity.

Operational characteristic

- 3 way valve with double poppet.
- Possibility to adjust the down stream circuit filling time by the enclosed adjustable metering screw.
- Quick down stream circuit discharge.
- Possibility for a pneumatic or electric piloting control.
- Body made with anodized 2011 aluminum alloy.
- Wall mounting possibility with M4 screws.

Technical characteristic

Connections	G 1/8" - G 1/4"
Max working pressure (bar)	10 bar - 1 MPa
Temperature °C	50°C
Weight	gr. 365
Assembly position	Any
Min. operating pressure	2,5 bar - 0,25 MPa
Nominal flow at 6 bar with $\Delta p=1$	1000 NI/min.
Flow with adjustable metering screw fully open	150 NI/min.
Wall fixing screw	M4

Shut-off valve

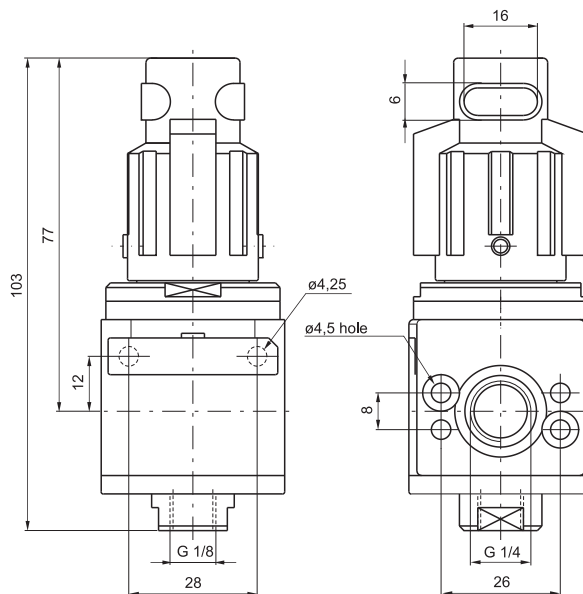

Ordering code

17V30.T

VERSION

- V** 0 = Zinc alloy body
- 1 = Technopolymer body

TYPE

- T** A = Not lockable handle
- B = Lockable handle

Example: 17130.B : Shut-off valve size 1 complete with lockable handle with technopolymer body.

Important note: the preventive or programmed maintenance of this product is not foreseen considering the elaborated assembling and the specific "PNEUMAX" testing; therefore, call the producer or its representative in case of necessity.

Operational characteristic

- 3 ways poppet valve.
- Zinc alloy body or reinforced technopolymer body with threaded aluminium insert connections.
- Double handle action for valve opening: pushing and rotating (clockwise).
- Simply rotate the valve handle counter clockwise for valve closing and down stream circuit discharging.
- Possibility to lock the valve in the discharging position by fitting in a padlock in the proper seat.
- Wall mounting possibility with M4 screws protected by covers.

Technical characteristic

Connections	G 1/8" - G 1/4"
Max working pressure (bar)	10 bar - 1,3 MPa
Temperature °C	50°C
Weight with technopolymer body	gr. 155
Weight with zinc alloy body	gr. 280
Assembly position	Any
Wall fixing screw	M4
Handle opening and closing angle	90°
Max. fittings torque on zinc alloy body	30 Nm
Max. fittings torque on technopolymer body	15 Nm

Progressive start-up valve

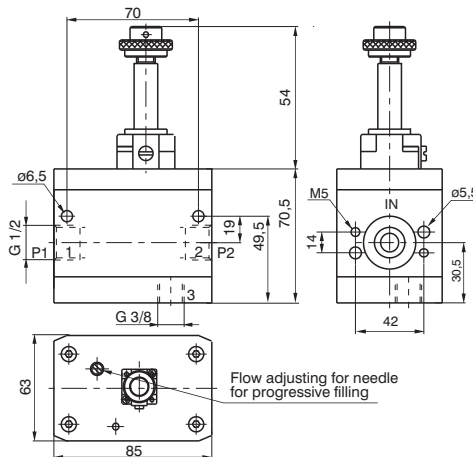

Ordering code

1730T

TYPE

- T** 10.M2 = Electric control complete with M2 mechanic (see pag. 2.15)
- 20 = with pneumatic control

Important note: the preventive or programmed Maintenance of this product is not foreseen considering the elaborated assembling and the specific "PNEUMAX" testing; therefore, call the producer or its representative in case of necessity.

Operating Characteristics

- 3 way valve with double poppet.
- Possibility to adjust the down stream circuit filling time by the enclosed adjustable metering screw.
- Quick down stream circuit discharge.
- Possibility for a pneumatic or electric piloting control.
- Body made with anodized 2011 aluminum alloy.
- Wall mounting possibility with M6 screws.

Technical characteristics

Connections	G 1/2"
Max working pressure (bar)	10 bar - 1 MPa
Temperature °C	-5 °C - 50°C
Weight	gr. 1010
Assembly position	Any
Wall fixing screw	M6
Min. working pressure	2,5 bar - 0,25 MPa
Nominal flow at 6 bar with Δp=1	2500 NI/min.
Flow with adjustable metering screw fully open	340 NI/min.

Shut-off valve

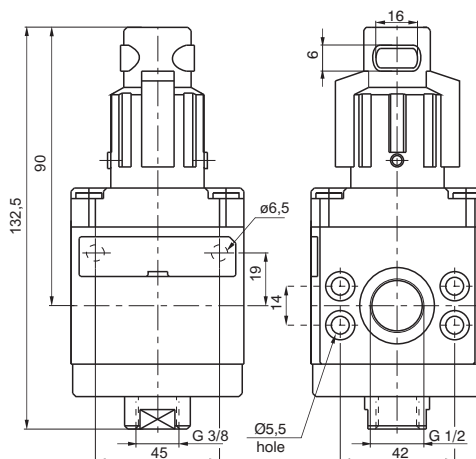

Ordering code

17330.T

TYPE

- T** A = Not lockable handle
- B = Lockable handle

Example: 17330.B

Shut-off valve size 3 complete with lockable handle.

Important note: the preventive or programmed Maintenance of this product is not foreseen considering the elaborated assembling and the specific "PNEUMAX" testing; therefore, call the producer or its representative in case of necessity.

Operating Characteristics

- 3 ways poppet valve.
- Body made with light alloy.
- Wall mounting possibility with M6 screws protected by covers.
- Double action handle for valve opening: pushing and rotating (clockwise).
- Simple rotate the valve handle counter clockwise for valve closing and down stream circuit discharging.
- Possibility to lock the valve in the discharging position by fitting in a padlock in the proper seat.

Technical characteristics

Connections	G 1/2"
Max working pressure (bar)	13 bar - 1,3 MPa
Temperature °C	-5 °C - 50°C
Weight	gr. 550
Assembly position	Any
Nominal flow at 6 bar with Δp=1	2500 NI/min.
Wall fixing screw	M6
Handle opening and closing angle	90°
Max. fittings torque	40 Nm

Progressive start-up valve

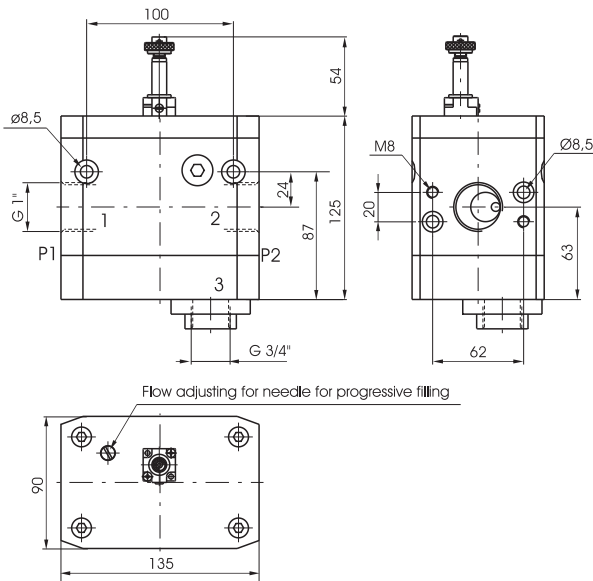

Ordering code

174T

TYPE

- T 10.M2 = Electric control complete with M2 mechanic (see page 2.13)
- 20 = with pneumatic control

Operational characteristic

- 3 way valve with double poppet.
- Possibility to adjust the down stream circuit filling time by the enclosed adjustable metering screw.
- Quick down stream circuit discharge.
- Possibility for a pneumatic or electric piloting control.
- Body made with anodized 2011 aluminum alloy.
- Wall mounting possibility with M8 screws.

Technical characteristic

Connections	G 1"
Max working pressure (bar)	10 bar - 1 MPa
Temperature °C	50°C
Weight	gr. 2300
Assembly position	Any
Wall fixing screw	M8
Min. working pressure	2,5 bar - 0,25 MPa
Nominal flow at 6 bar with Δp=1	8000 NI/min.
Flow with adjustable metering screw fully open	3000 NI/min.

Shut-off valve

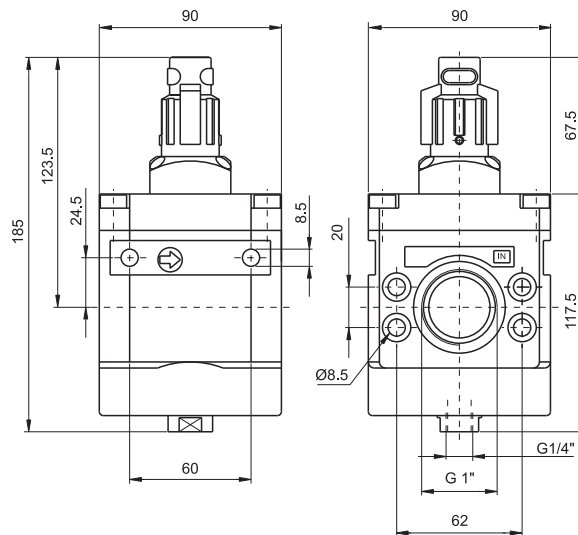

Ordering code

17430.T

TYPE

- T A = Not lockable handle
- B = Lockable handle

Example: 17430.B

Shut-off valve size 4 complete with lockable handle.

Important note: the preventive or programmed maintenance of this product is not foreseen considering the elaborated assembling and the specific PNEUMAX testing; therefore, call the producer or its representative in case of necessity.

Operational characteristic

- 3 ways poppet valve.
- Body made with light alloy.
- Wall mounting possibility with M8 screws protected by covers.
- Double action handle for valve opening: pushing and rotating (clockwise).
- Simple rotate the valve handle counter clockwise for valve closing and down stream circuit discharging.
- Possibility to lock the valve in the discharging position by fitting in a padlock in the proper seat.

Technical characteristic

Connections	G 1"
Max working pressure (bar)	10 bar - 1 MPa
Temperature °C	50°C
Weight	gr. 1600
Assembly position	Any
Nominal flow at 6 bar with Δp=1	8000 NI/min.
Wall fixing screw	M8
Handle opening and closing angle	90°