

**Ordering code**

6500.Ø.stroke. 1 .

10	= non magnetic
16	
20	
25	

**M** = magnetic

**Construction characteristics**

Body	anodised aluminium
Piston rod	stainless steel
Piston	brass
Rods bushing	sinterize bronze
End plate	anodised aluminium
Cushioning washer	PUR
Seal	oil resistant NBR rubber

**Technical characteristics**

Fluid	filtered and preferably lubricated air or not (If lubricated the lubrication must be continuous)
Minimum working pressure	0.6 bar (for bore Ø10 - Ø16) 0.5 bar (for bore Ø20 - Ø32)
Max pressure	7 bar
Operating temperature	-5°C - +70°C
Cushioning	with elastic bumper
Stroke tolerance	+1 / 0 mm
Piston speed	50 - 500 mm/sec (without load)

**Corse standard**

Bore	Stroke							
	5	10	15	20	25	30	40	50
Ø10	●	●	●	●	●	●		
Ø16	●	●	●	●	●	●		
Ø20	●	●	●	●	●	●	●	●
Ø25	●	●	●	●	●	●	●	●

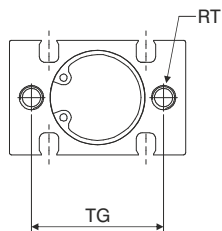

\* $\varnothing 10$ : n° 2 piston rod nuts  
 $\varnothing 16$ : n° 1 piston rod nut

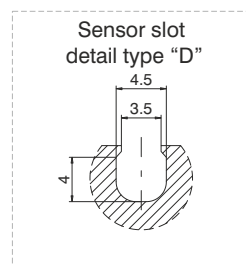
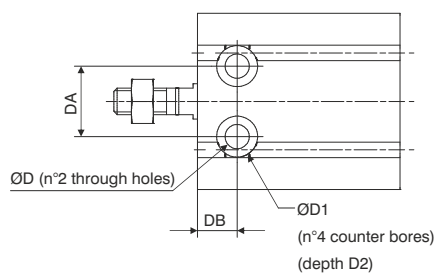
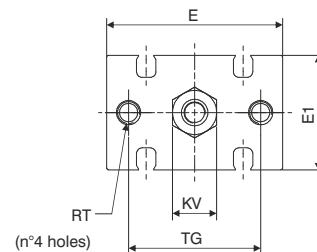
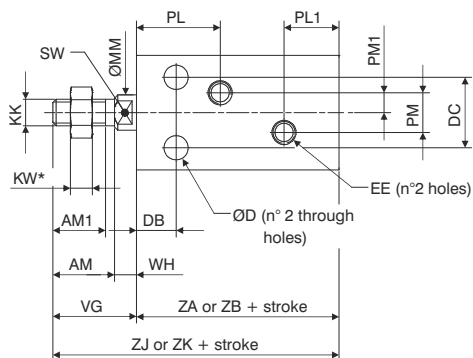

Table of dimensions

	Bore				
	$\varnothing 10$	$\varnothing 16$	$\varnothing 20$	$\varnothing 25$	
AM	/	12,5	14	18	
AM1	10	11	12	15,5	
$\varnothing D$	$\varnothing 3,2$	$\varnothing 4,5$	$\varnothing 5,5$	$\varnothing 5,5$	
$\varnothing D1$	$\varnothing 6$	$\varnothing 7,6$	$\varnothing 9,3$	$\varnothing 9,3$	
D2	5	6,5	8	9	
DA	11	14	16	20	
DB	7	7	9	10	
DC	9	12	16	20	
E	24	32	40	50	
E1	15	20	26	32	
EE	M5	M5	M5	M5	
KK	M4	M5	M6	M8	
KV	7	8	10	13	
KW	3	4	5	5	
$\varnothing MM$	$\varnothing 4$	$\varnothing 6$	$\varnothing 8$	$\varnothing 10$	
PL	16,5	16,5	19	21,5	
PL1	10	11,5	12,5	13	
PM	/	4	9	9	
PM1	/	2	4,5	4,5	
RT	M3 (useful depth 5)	M4 (useful depth 6)	M5 (useful depth 8)	M5 (useful depth 8)	
SW	/	5	6	8	
TG	18	25	30	38	
VG	16	16	19	23	
WH	/	3,5	5	5	
ZA	magnetic	36	40	46	50
ZB	non magnetic	36	30	36	40
ZJ	magnetic	52	56	65	73
ZK	non magnetic	52	46	55	63
<b>Weight (gr.)</b>					
Stroke 0	32	44	84	159	
every 5 mm	4	6	11	17	